

Bus/Maint
501

B & F
u
s
i
r
e

L
a
n
e

N
o

P
u
b
l
i
c

T
r
a
f
f
i
c

D
u
r
i
n
g

S
c
h
o
o
l

D
a
y
s

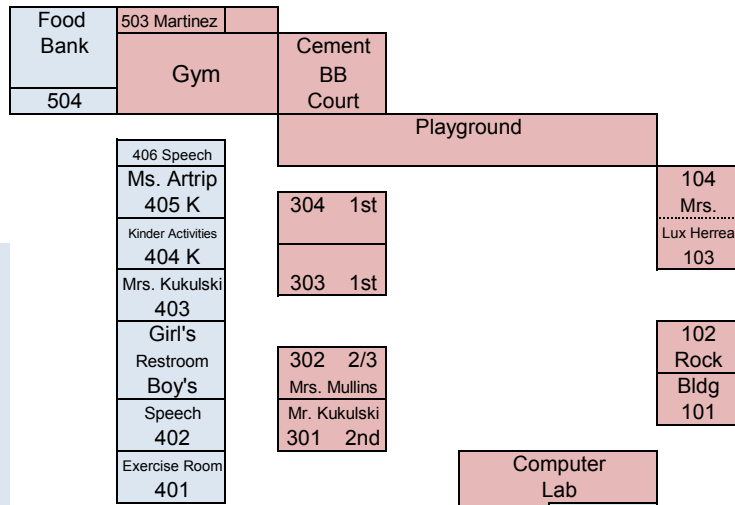

Z
O
N
E
3

Z
O
N
E
4

upper field

During an emergency situation
Parents will need to report to the main office to show ID & proceed to the board room to retrieve their student.

To access staff extensions add a 1 in front of the 3 digit room number when dialing . Except Front Office numbers- Simply dial the room number.

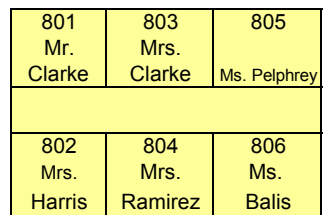
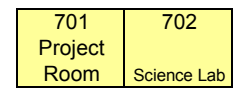
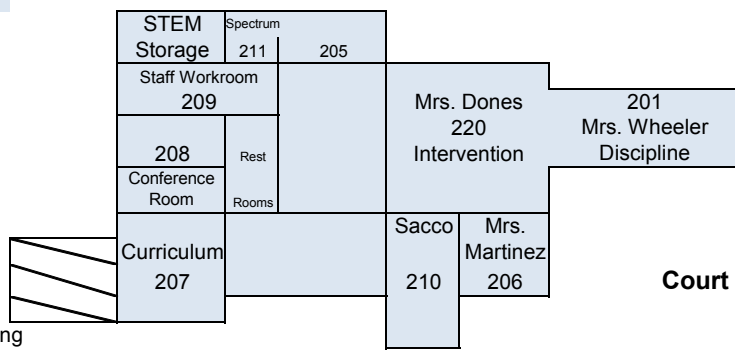
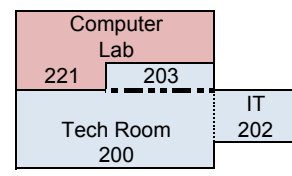
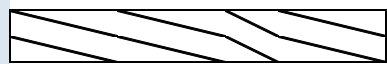
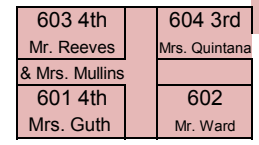

Court Yard

Bus Loading Zone

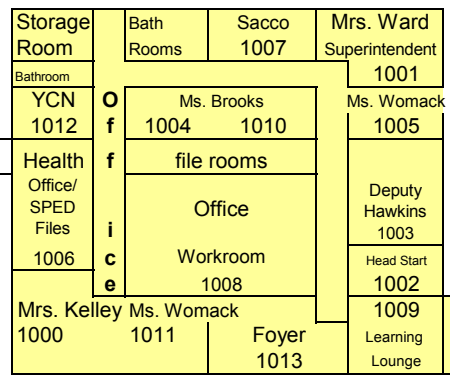
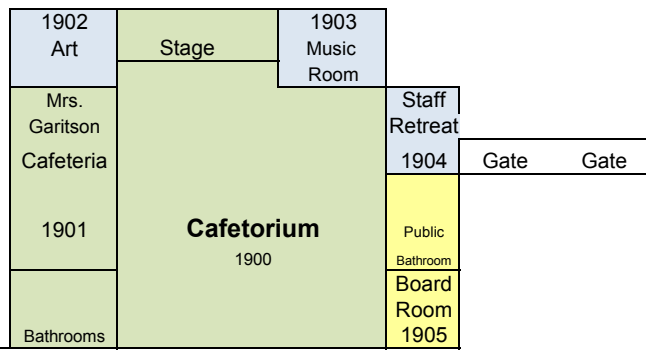

Z
O
N
E
1

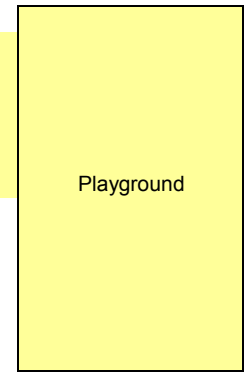

ZONE 1

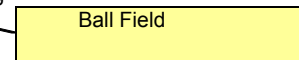
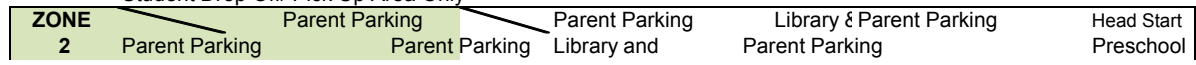
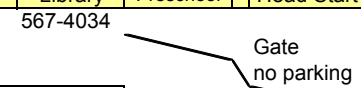
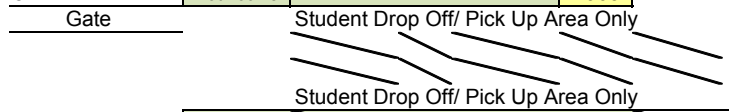

Staff Parking

Staff Parking

Staff Parking

Staff Parking

Parking



501
Bus Barn

B & F
u s
L a n e
N o
P u b l i c
T r a f f i c
D u r i n g
S c h o o l
D a y

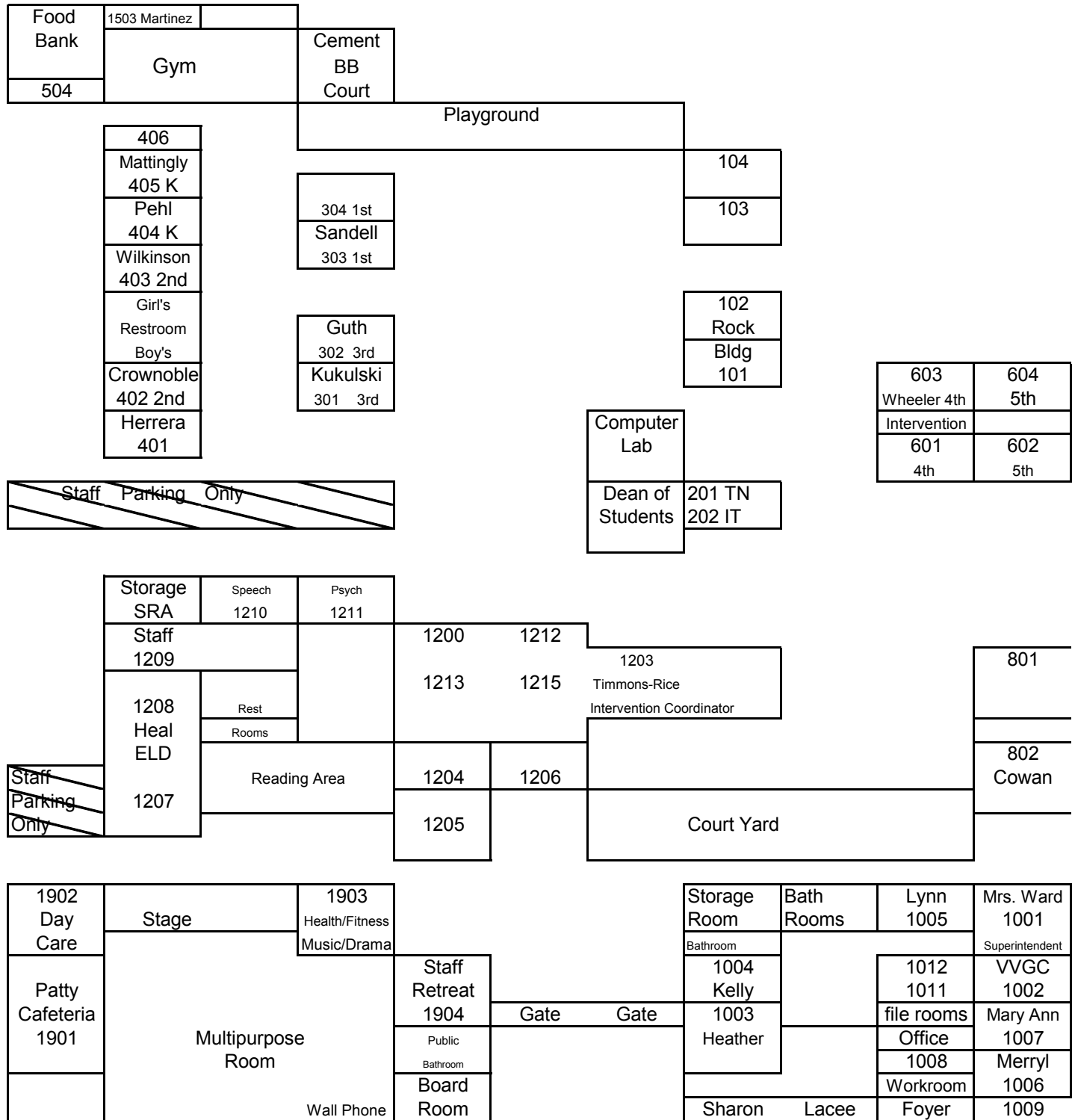

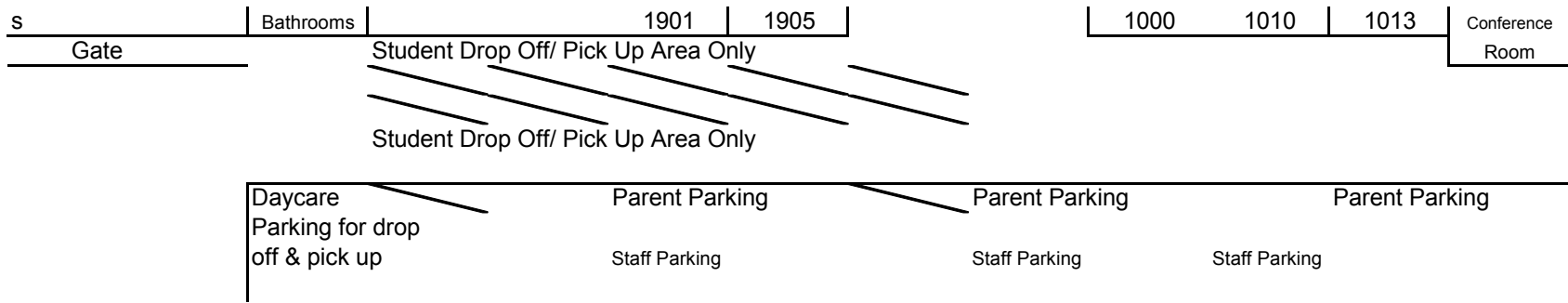

#####

upper field

|

701 STEM Science	702 Science Lab 6/7/8 Science
------------------------	-------------------------------------

803	805 R Franklin 7/8 History
-----	----------------------------------

804 T Franklin	806 Klein 7/8 Math
-------------------	--------------------------

During an emergency situation

Parents will need to report to the main office to show ID & proceed to the board room to retrieve their student.

head start
preschool
playground

Kathryn	Head Start		Preschool
---------	------------	--	-----------

Playground

1014 Library	1016		1017
-----------------	------	--	------

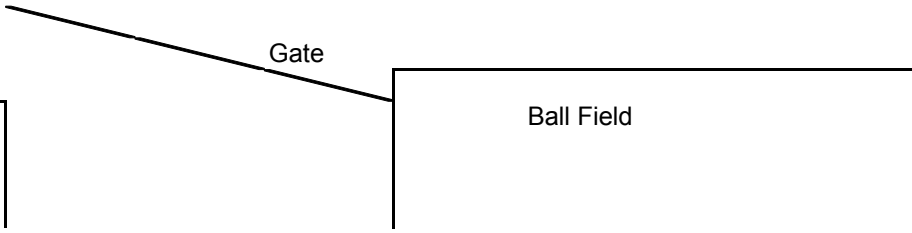

Head Start
Preschool
Parking

Ball Field